

Two-Tank Pyroweeder Upgrade

ASSEMBLY AND INSTRUCTION MANUAL



This kit includes:

- 1 × Two-Tank Adapter
(plumbing version only)
- 2 × Auxiliary Tank Braces
- 2 × Bungee Cords
- 2 × 1/4"-20, 1 3/4" Carriage Bolts
(plumbing version only)
- 4 × 3/8"-16, 3 1/2" Carriage Bolts

Tools and Parts Needed

- 2 × 20-lb propane tank
- 1 × 7/16" wrench *(plumbing version only)*
- 1 × 9/16" wrench

STEP 1

Attach Auxiliary Tank Braces to Tool Cart

1. Remove the four $\frac{3}{8}$ "-16, 3" Carriage Bolts that attach the axle bars to the Main Bar of the Tool Cart. Save the nuts and washers to re-attach the the axle bars. The Axle Bars are temporarily detached at this point.
2. Place the two Auxiliary Tank Braces on the front side of the Main Bar as shown.
3. Attach the Auxiliary Tank Braces using the four $\frac{3}{8}$ "-16, 3 $\frac{1}{2}$ " Carriage Bolts (replacing the bolts that you removed). Use the nuts and washers saved earlier to re-attach the Axle Bars and the Auxiliary Tank Braces.
4. Tighten the four nuts just enough so that the Auxiliary Tank Braces are secure and the Axle Bars remain fixed in alignment with the Main Bar.

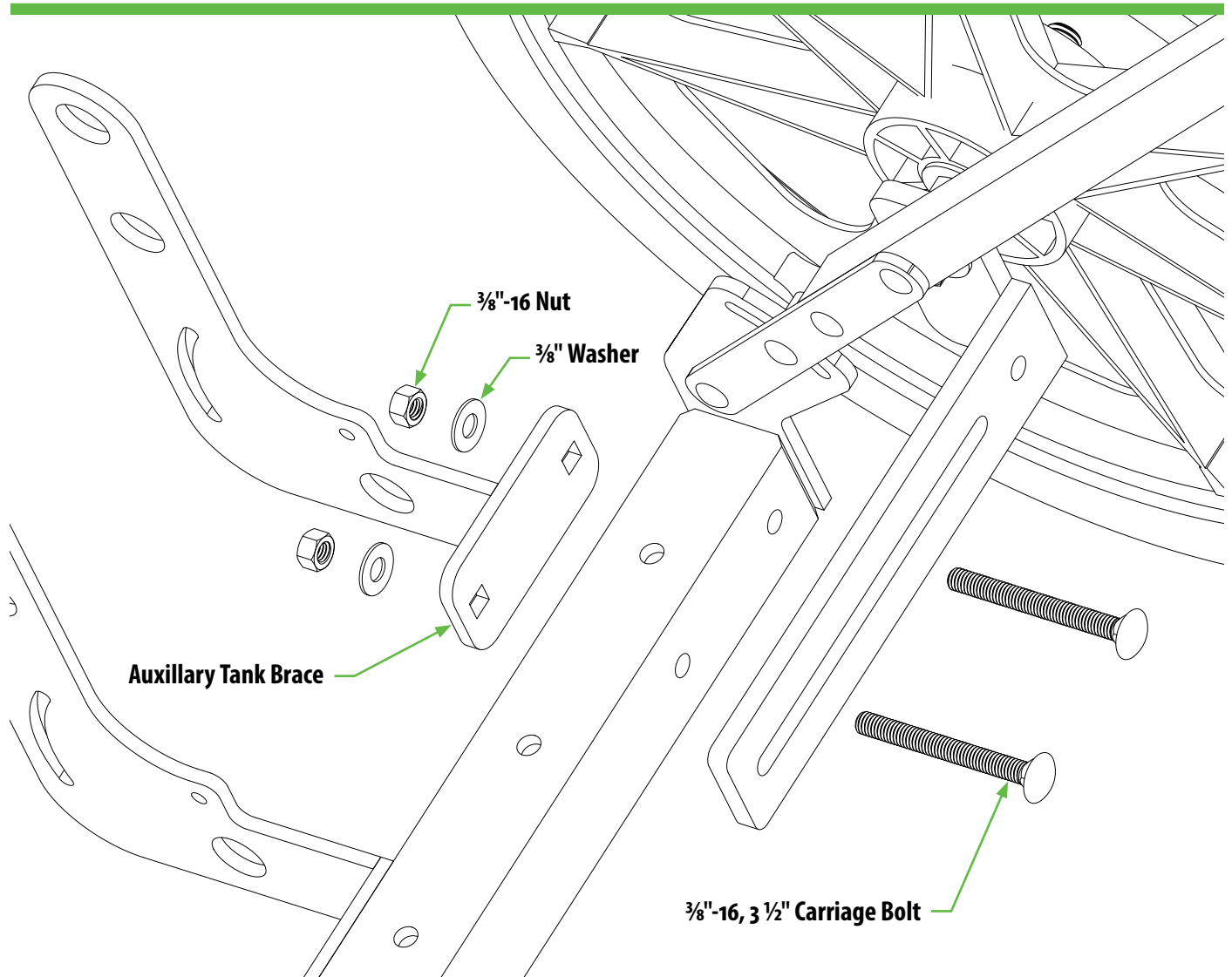

STEP 2

Attach Two-Tank Adapter

(plumbing version only)

1. Remove the two 1/4"-20, 1-1/2" Carriage Bolts connecting the straight-side bar to the lower handle tie. Replace them with the supplied 1/4"-20, 1-3/4" Carriage Bolts, connecting the Two-Tank Adapter to the Pyroweeder as shown.

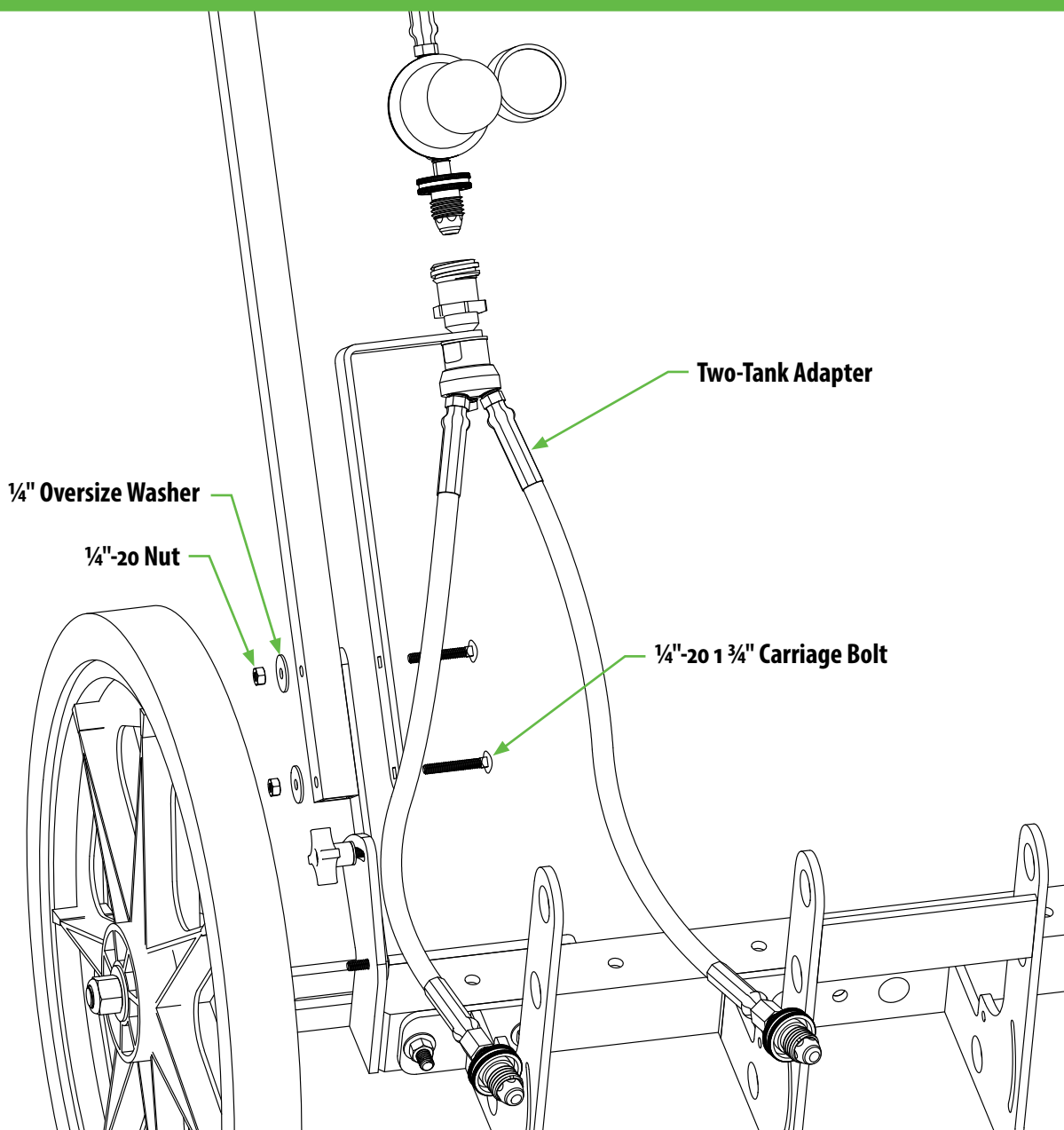

STEP 3

Attach Two Propane Tanks

1. Place two 20-lb propane tanks side by side on the Tool Cart as shown.
2. Using two Bungee Cords each, secure each tank to an Auxiliary Tank Brace and one side of the central Tank Brace as shown.



STEP 4

Lighting the Pyroweeder

1. Operating a two-tank Pyroweeder is very similar to a single-tank version. To light a two-tank Pyroweeder, start with the control valve completely closed. Open both tank valves before opening the control valve. Continue with the single-tank Pyroweeder instructions on page 16, point 3, after “open the tank valve first”.